



Double Storey Terrace

AFFORDABLE IN GREEN

AFFORDABLE IN GREEN

Taman Permaipura is a modern and contemporary concept development and is surrounded by natural greenery complete with various facilities for your family. Built on 58.92 acres of land, equipped with various facilities and strategically located close to access to the North-South Expressway (PLUS) and Permaipura Golf Club. The home that is the dream of every family has become easier to live in at an affordable price.



Gated & Guarded



Water Heater Point



A/C Piping



Brickwall Fencing



Concrete Imprint



FLOOR PLAN

2 Storey Terrace

1,400 – 4,510 sq.ft.
Land Area

1,953 – 2,519 sq.ft.
Built-Up Area

4
Bedrooms

3
Bathrooms

GROUND FLOOR PLAN

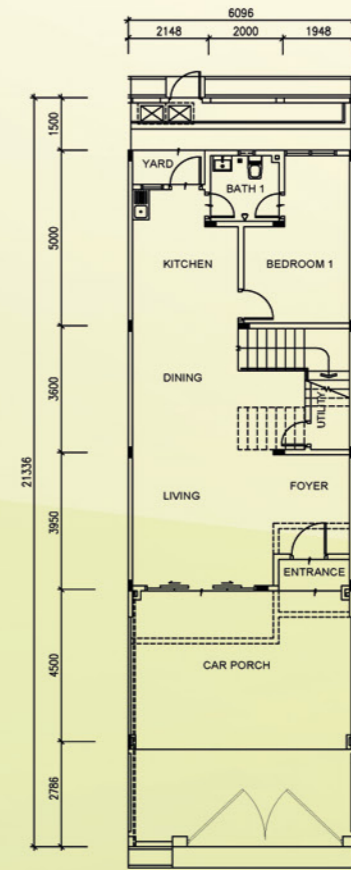

1st FLOOR PLAN

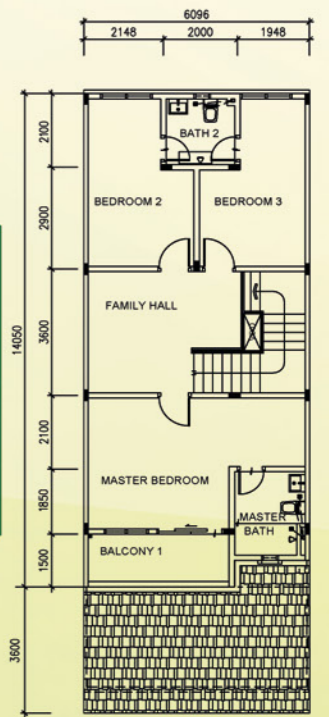

A two-story terraced house in **Taman Permaipura** offers a contemporary design and impeccable layout. The blend of high ceilings, spacious rooms, and ample family living space creates a harmonious ambiance and a quality lifestyle for your entire family.



LEGEND
2 STOREY TERRACE

SITE PLAN

LOCATION MAP



THE BEST ACCESS FOR YOUR CONVENIENCE



OIB Sales Gallery (Sungai Petani)
 22, Lengkok Cempaka 1,
 Persiaran Cempaka, Amanjaya,
 08000 Sungai Petani, Kedah

04-4481888

f OIBgroup www.oibgroup.com

